

# GUIDA RAPIDA MONTAGGIO E AVVIAMENTO

# 4SISON®

## Disinballare l'Unità

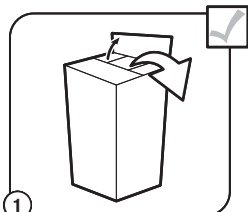

1 Rimuovere tutto il contenuto dal cartone.

## Assemblare l'Unità

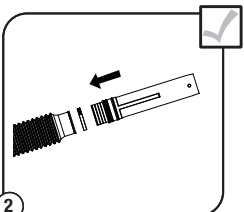

2 Montare il tubo di controllo sul tubo flessibile. Rafforzare la connessione con il morsetto.

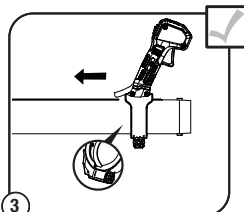

3 Fissare l'impugnatura al tubo di controllo. Bloccare il dado per fissare la maniglia dopo averla regolata nella migliore posizione operativa. Raddoppia il fissaggio con la leva clip a fissaggio rapido.

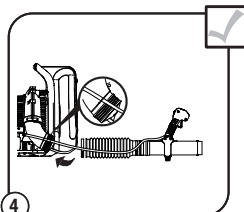

4 Installare il tubo flessibile sul gomito del soffiatore e serrare la fascetta. Usare la fascetta per fissare il cavo dell'acceleratore.

**NON SI È AVVIATO?**  
Ripetere le istruzioni di avviamento. Se l'unità continua a non avviarsi, fare riferimento al manuale dell'operatore per ulteriori informazioni sull'avvio e la risoluzione dei problemi.

MODELLO  
BLB4QL-M

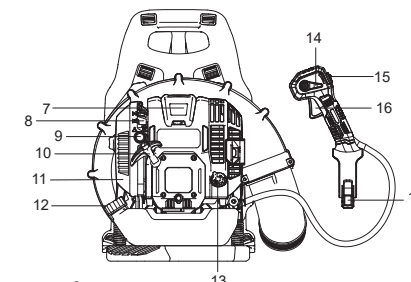

## Assemblare l'Unità

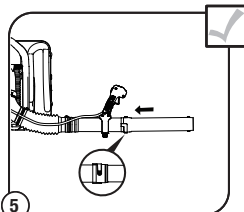

5 Allineare e ruotare di 90° per fissare il tubo intermedio al tubo di controllo. Assicurarsi che il tubo intermedio sia ben inserito e quindi serrare la vite.

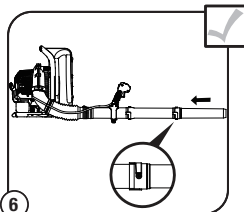

6 Allineare e ruotare il tubo del soffiatore a 90° in senso orario per montarlo sul tubo intermedio quindi serrare la vite.

## Olio e Benzina

AVVISO: Il soffiatore viene spedito senza olio nel carter. L'olio deve essere aggiunto prima di iniziare.

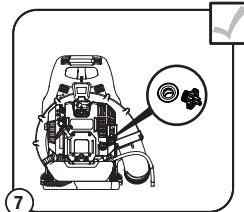

7 Posizionare l'unità su una superficie piana e livellata. Svitare il tappo del serbatoio dell'olio. Versare 170 ml (5.7 Oz.) di olio nel serbatoio dell'olio. Asciugare l'olio versato e reinstallare il tappo del serbatoio dell'olio. NOTA: NON riempire in eccesso. Non aggiungere mai olio al serbatoio del carburante. NON mescolare olio con benzina.

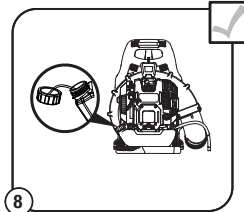

8 Posizionare l'unità con il tappo del serbatoio carburante rivolto verso l'alto. Rimuovere il tappo del serbatoio. Riempire il serbatoio. Asciugare il carburante versato e reinstallare il tappo del serbatoio. Spostare il soffiatore ad almeno 9 m dalla tanica carburante e dal punto di rifornimento prima di avviare il motore. NOTA: NON riempire in eccesso. Utilizzare benzina senza piombo nuova.

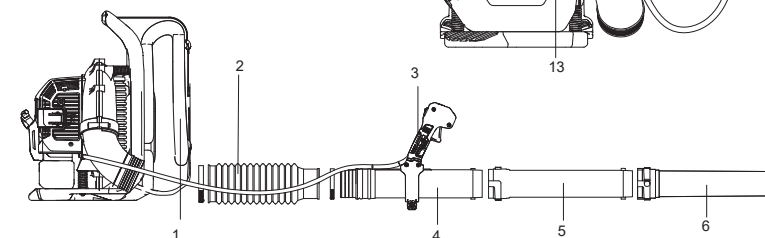

1. Spallaccio
2. Tubo Flessibile
3. Impugnatura Gas
4. Tubo di Controllo
5. Tubo Intermedio
6. Tubo Terminale
7. Coperchio Candela
8. Leva Aria
9. Primer Innesco

10. Impugnatura Avviamento
11. Coperchio Filtro Aria
12. Tappo Serbatoio Benzina
13. Tappo Olio Motore
14. Leva Cruise Control
15. Interruttore On/Off
16. Leva Acceleratore
17. Leva Fissaggio Rapido

## Avviare l'Unità

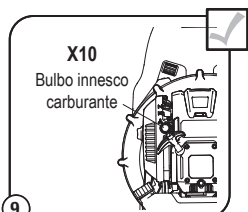

9 **X10**  
Bulbo innesco carburante  
Premere e rilasciare lentamente la pompetta di adescamento 10 volte.

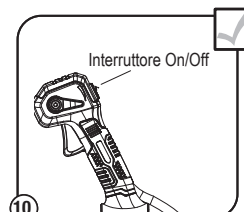

10 Interruttore On/Off  
Attivare l'interruttore on/off sull'impugnatura.

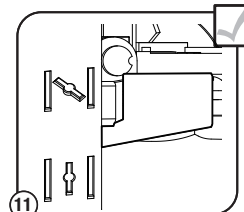

11 Spostare la leva dello starter verso l'alto per chiudere lo starter.

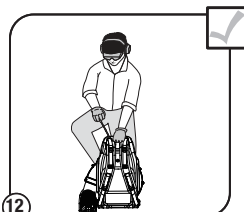

12 Accovacciati nella posizione di avviamento.

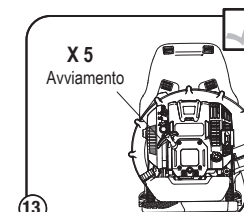

13 **X5**  
Avviamento  
Tirare la fune di avviamento a strappo con un movimento controllato e costante per 5 volte fino a sentire la deflagrazione del motore.

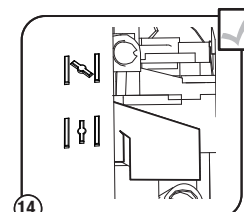

14 Spostare la leva dell'aria verso il basso per aprire lo starter.

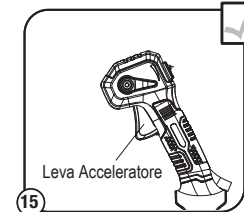

15 Leva Acceleratore  
Quando il motore si avvia, premere il grilletto dell'acceleratore per far aumentare i giri del motore. Maggiore è la pressione applicata, più veloce il motore funzionerà.



**IMPORTANTE: LEGGERE ATTENTAMENTE IL MANUALE DELL'OPERATORE E SEGUIRE LE PRATICHE OPERATIVE E LE NORME DI SICUREZZA DURANTE IL FUNZIONAMENTO DELL'UNITÀ.**  
[www.sabreitalia.com](http://www.sabreitalia.com) per domande o per trovare altri prodotti 4SISON di qualità.



# QUICK START GUIDE

# 4SISON®

MODEL No.  
BLB4QL-M

## Unpacking the Unit

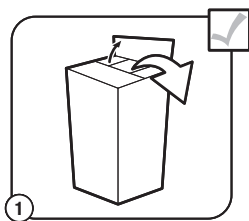

1 Remove all contents from the carton.

## Assembling the Unit

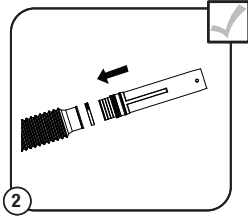

2 Mount the control pipe to the flexible pipe. Reinforce the connection by the clamp.

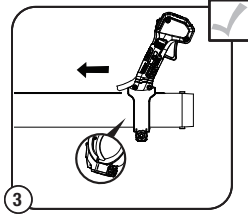

3 Attach the handle to the control pipe. Lock the nut to fix the handle after adjusting to the best operation position. Double secure the handle by the quick clip.

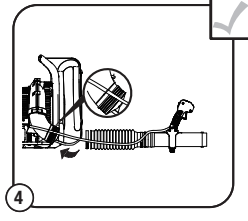

4 Install the flexible pipe on the blower elbow and tighten the clamp. Use the wire clamp to secure the throttle line.

**DIDN'T START?**  
Repeat the starting instructions. If the unit still fails to start, refer to the operator's manual for additional starting and troubleshooting information.

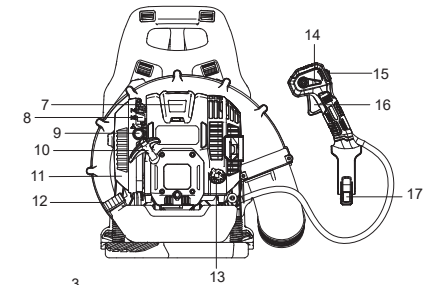

## Assembling the Unit

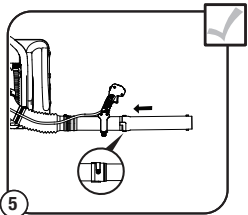

5 Align and rotate 90° for attaching the intermediate pipe to the control pipe. Make sure the intermediate pipe is in place then tighten the screw.

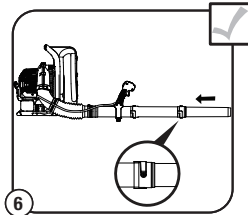

6 Align and rotate the blower pipe 90° clockwise for mounting it on the intermediate pipe then tighten the screw.

## Oil and Fuel

**NOTICE:** The blower is shipped without oil in the crankcase. Oil must be added before starting.

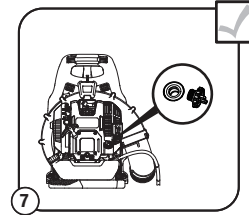

7 Set the unit on a flat, level surface. Unscrew the oil tank cap. Pour 170ml (5.7 fluid oz.) oil into the oil tank. Wipe up spilled oil and reinstall the oil tank cap. **NOTE: DO NOT overfill. Never add oil to the fuel tank. DO NOT mix oil with gasoline.**

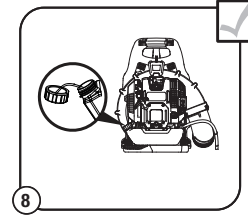

8 Position the unit with the fuel tank cap facing up. Remove the fuel tank cap. Fill the tank. Wipe up spilled fuel and reinstall the fuel tank cap. Move the unit at least 9.1m(30 ft.) from the fuel container and the fueling site before starting the engine. **NOTE: DO NOT overfill. Use fresh unleaded gasoline (less than 30 days old).**

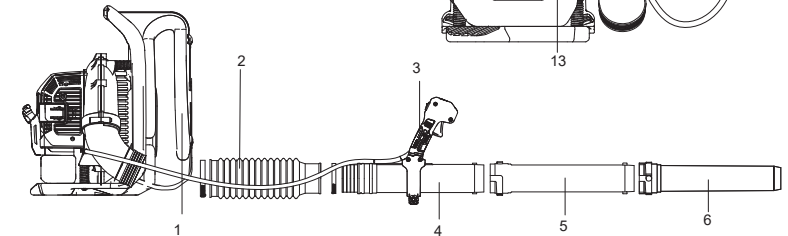

1. Shoulder Harness
2. Flexible Pipe
3. Handle
4. Control Pipe
5. Intermediate Pipe
6. Blower Pipe
7. Spark Plug Cover
8. Choke Lever
9. Primer Bulb

10. Recoil Starter Handle
11. Air Filter Cover
12. Fuel Tank Cap
13. Oil Tank Cap
14. Throttle Position Lever
15. On/Off Switch
16. Throttle Trigger
17. Quick Clip

## Starting the Unit

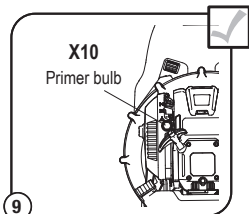

9 **X10** Primer bulb  
Slowly press and release the primer bulb 10 times.

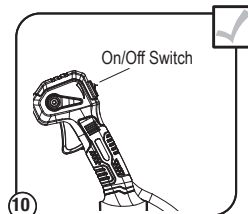

10 On/Off Switch  
Turn on the on/off switch on the handle.

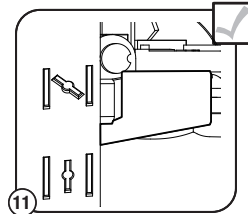

11 Move the choke lever up for closing the choke.

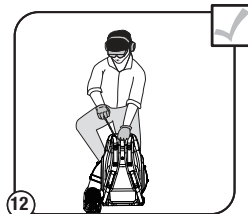

12 Crouch in the starting position.

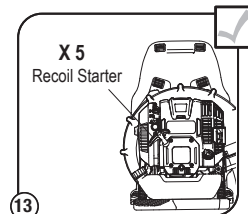

13 **X5** Recoil Starter  
Pull the recoil starter rope with a controlled and steady motion 5 times until you can hear the deflagration of engine.

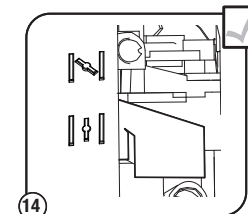

14 Move the choke lever down to open the choke.

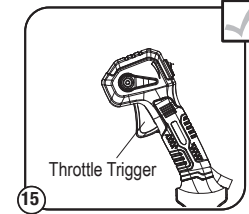

15 Throttle Trigger  
When the product starts, squeeze the throttle trigger to increase engine speed. The more pressure you apply, the faster it will run.



**IMPORTANT: READ THE OPERATOR'S MANUAL THOROUGHLY AND FOLLOW THE SAFE OPERATION PRACTICES WHILE OPERATING THE UNIT.**

www.sabreitalia.com for questions or to find other quality 4SISON products.



# GUÍA DE INICIO RÁPIDO

# 4SISON®

MODELO No.  
BLB4QL-M

## Desempaque de la unidad

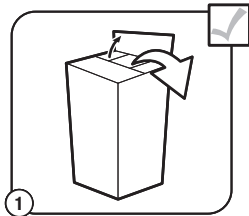

1 Retire todo el contenido de la caja.

## Armado de la unidad

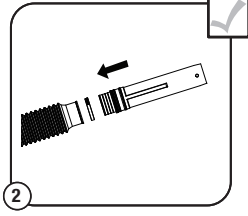

2 Monte el tubo de control al tubo flexible. Refuerce la conexión mediante la abrazadera.

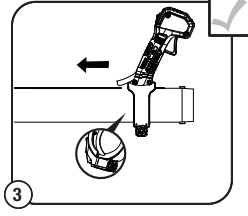

3 Conecte el mango al tubo de control. Bloquee la tuerca para fijar el mango después de ajustarse a la mejor posición de operación. Asegure dos veces el mango con el clip rápido.

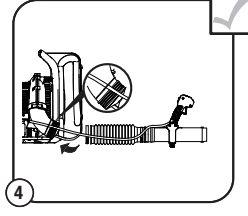

4 Instale el tubo flexible en el codo del soplador y ajuste la abrazadera. Utilice la abrazadera de alambre para asegurar la línea del acelerador.

**¿NO ARRANCÓ?**  
Repita las instrucciones de inicio. Si la unidad aún no arranca, consulte el manual del operador para obtener información adicional sobre arranque y solución de problemas.

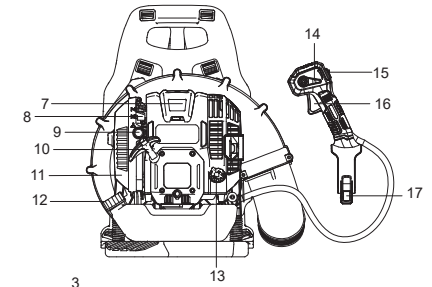

## Armado de la unidad

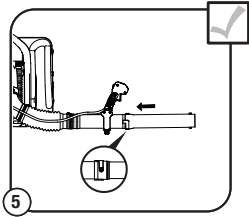

5 Alinee y gire 90° para conectar el tubo intermedio al tubo de control. Asegúrese de que el tubo intermedio esté en su lugar y luego ajuste el tornillo.

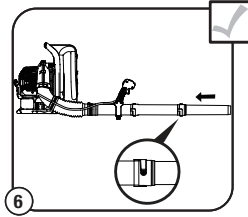

6 Alinee y gire el tubo del soplador 90° en el sentido de las agujas del reloj para montarla sobre el tubo intermedio y luego ajuste el tornillo.

## Aceite y combustible

AVISO: El soplador se envía sin aceite en el cárter. Se debe añadir aceite antes de poner la herramienta en marcha.

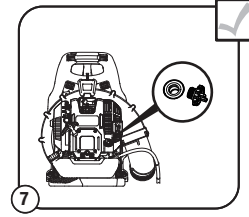

7 Deposite la herramienta sobre una superficie plana y nivelada. Desenrosque la tapa del tanque de aceite. Vierta 170 ml (5.7 onzas líquidas) de aceite en el tanque de aceite. Limpie el aceite derramado y vuelva a instalar la tapa del tanque de aceite.  
NOTA: NO llene en exceso. Nunca agregue aceite al depósito de combustible. NO mezcle aceite con gasolina.

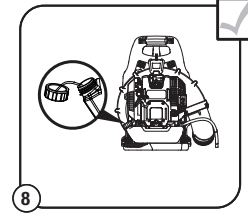

8 Posicione la unidad con la tapa del tanque de combustible dirigida hacia arriba. Retire la tapa del tanque de combustible. Llene el tanque. Limpie el combustible derramado y vuelva a instalar la tapa del tanque de combustible y del área de llenado de combustible antes de arrancar el motor.  
NOTA: NO llene en exceso. Utilice gasolina nueva sin plomo (de menos de 30 días).

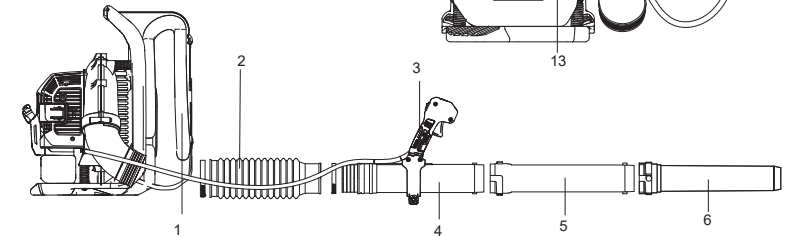

1. Arnés del hombro
2. Tubo flexible
3. Mango
4. Tubo de control
5. Tubo intermedio
6. Tubo del soplador
7. Cubierta de la bujía
8. Palanca de estrangulación
9. Perilla de cebado

10. Mango del arrancador de retroceso
11. Cubierta del filtro de aire
12. Tapa del tanque de combustible
13. Tapa del tanque de aceite
14. Palanca de posición del acelerador
15. Interruptor de encendido/apagado
16. Gatillo de aceleración

## Arranque de la unidad

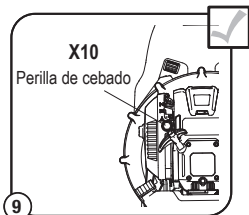

9 **X10**  
Perilla de cebado  
Presione y suelte lentamente la perilla de cebado 10 veces.

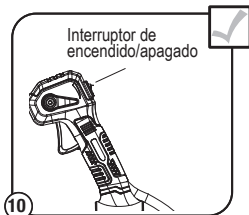

10 Interruptor de encendido/apagado  
Encienda el interruptor de encendido/apagado en el mango.

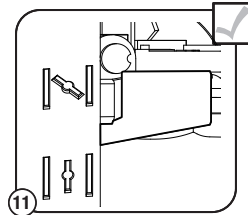

11 Mueva la palanca de estrangulamiento hacia arriba para cerrar el estrangulador.

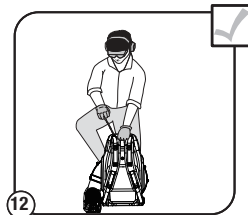

12 Agáchese en posición de arranque.

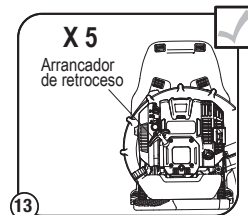

13 **X5**  
Arrancador de retroceso  
Tire de la cuerda de arranque con un movimiento controlado y constante 5 veces hasta que pueda escuchar la puesta en marcha del motor.

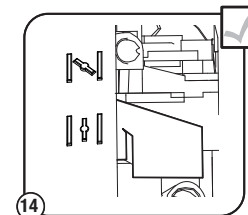

14 Mueva la palanca de estrangulamiento hacia abajo para abrir el estrangulador.

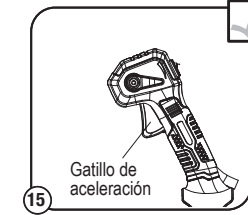

15 Gatillo de aceleración  
Cuando el producto arranque, ajuste el gatillo de aceleración para aumentar la velocidad del motor. Cuanta más presión aplique, más rápido funcionará.



**IMPORTANTE: LEA DETENIDAMENTE EL MANUAL DEL OPERADOR Y SIGA LAS PRÁCTICAS DE OPERACIÓN SEGURA MIENTRAS OPERA LA UNIDAD.**

www.sabreitalia.com para preguntas o para encontrar otros productos 4SISON de calidad.



## Déballage de l'unité

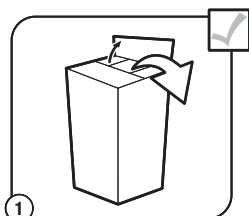

1 Retirez tout le contenu du carton d'emballage.

## Assemblage de l'unité

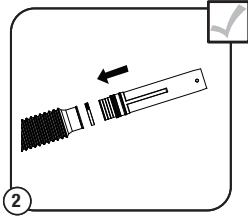

2 Montez le tube de commande sur le tuyau flexible. Renforcez la connexion par le collier de serrage.

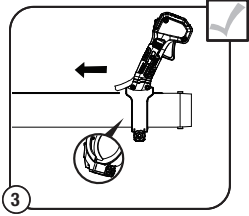

3 Fixez la poignée au tube de commande. Verrouillez l'écrou pour fixer la poignée après l'avoir ajustée à la meilleure position de fonctionnement. Sécurisez la poignée à l'aide du clip rapide.

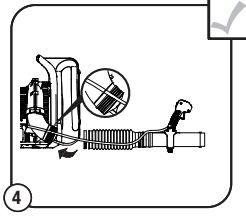

4 Installez le tuyau flexible sur le coude du souffleur et serrez le collier. Utilisez le collier de serrage pour fixer la ligne de l'accélérateur.

## L'APPAREIL NE DÉMARRE PAS ?

Répétez les instructions de démarrage. Si l'appareil ne démarre toujours pas, reportez-vous au manuel d'utilisation pour plus d'informations concernant le démarrage et le dépannage.

N° de modèle  
BLB4QL-M

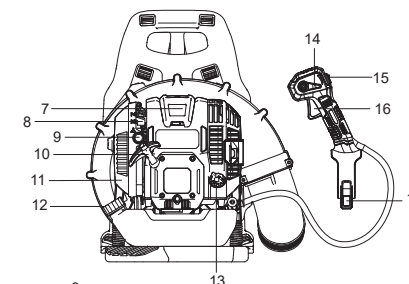

## Assemblage de l'unité

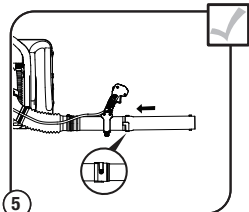

5 Alignez et tournez de 90° pour fixer le tube intermédiaire au tube de commande. Assurez-vous que le tuyau intermédiaire est en place puis serrez la vis.

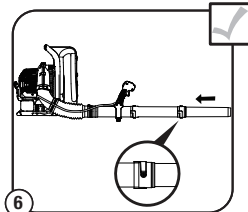

6 Alignez et tournez le tuyau du ventilateur de 90° dans le sens des aiguilles d'une montre pour le monter sur le tuyau intermédiaire puis serrez la vis.

## Huile et carburant

REMARQUE: Le souffleur est expédié sans huile dans le carter. L'huile doit être ajoutée avant de commencer à utiliser l'appareil.

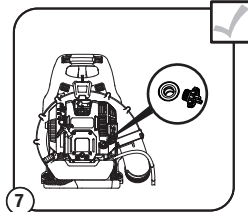

7 Placez l'appareil sur une surface plane et nivelée. Dévissez le bouchon du réservoir d'huile. Versez 170 ml (5,7 oz liquides) d'huile dans le réservoir d'huile. Essayez l'huile renversée et réinstallez le bouchon du réservoir d'huile. REMARQUE: NE remplissez PAS trop le réservoir. N'ajoutez jamais d'huile dans le réservoir de carburant. NE mélangez PAS l'huile avec l'essence.

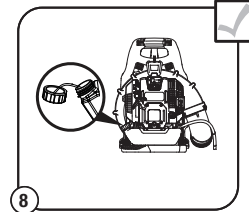

8 Positionnez l'appareil avec le bouchon du réservoir d'essence vers le haut. Retirez le bouchon du réservoir de carburant. Remplissez le réservoir. Essayez le carburant renversé et réinstallez le bouchon du réservoir de carburant. Déplacez l'appareil à au moins 9,1 m (30 pi) du réservoir de carburant et du site de ravitaillement avant de démarrer le moteur. REMARQUE: NE remplissez PAS trop le réservoir. Utilisez de l'essence sans plomb fraîche (de moins de 30 jours).

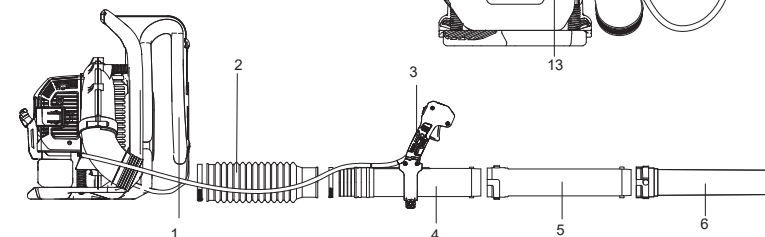

1. Harnais d'épaule
2. Tuyau flexible
3. Poignée
4. Tube de commande
5. Tuyau intermédiaire
6. Tuyau du souffleur
7. Couvercle de la bougie d'allumage
8. Levier du démarreur
9. Poire d'amorçage

10. Poignée du démarreur à rappel
11. Couvercle du filtre à air
12. Bouchon du réservoir de carburant
13. Bouchon du réservoir d'huile
14. Levier de position de l'accélérateur
15. Interrupteur marche / arrêt
16. Gâchette d'accélération
17. Clip rapide

## Démarrer l'appareil

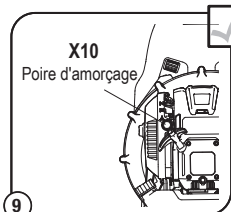

9 Appuyez et relâchez lentement la poire d'amorçage 10 fois.

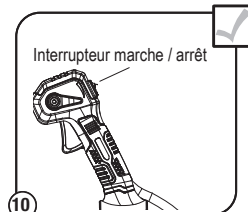

10 Allumez l'interrupteur marche/arrêt sur la poignée.

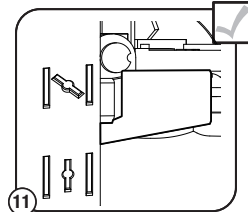

11 Déplacez le levier du starter vers le haut pour fermer le starter.

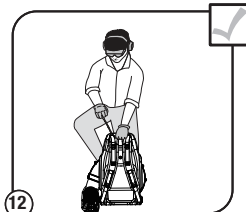

12 Accroupissez-vous pour vous mettre en position de démarrage.

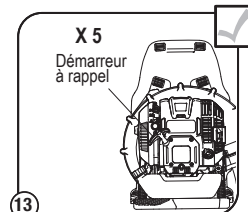

13 Tirez la corde du démarreur avec un mouvement contrôlé et régulier 5 fois jusqu'à ce que vous puissiez entendre la déflagration du moteur.

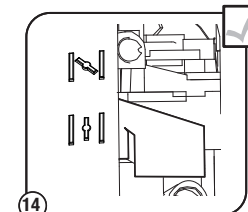

14 Déplacez le levier du starter vers le bas pour ouvrir le starter.

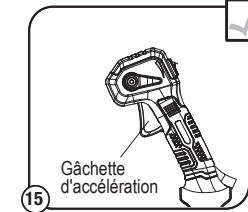

15 Lorsque le produit démarre, appuyez sur la gâchette de l'accélérateur pour augmenter la vitesse du moteur. Plus vous exercez de pression, plus le moteur tournera vite.



**IMPORTANT : LISEZ ATTENTIVEMENT LE MANUEL D'UTILISATION ET RESPECTEZ LES PRÉCAUTIONS DE SÉCURITÉ PENDANT L'UTILISATION DE L'APPAREIL.**

www.sabreitalia.com pour des questions ou pour trouver d'autres produits 4SISON de qualité.

